



# Controll-A-Door® P

Product Code  
**062708/062709**

DIAMOND WQ – WHISPER QUIET



## Description:

B&D's Controll-A-Door® P (CAD P) Diamond WQ - Whisper Quiet automatic opener is leading the way in smooth, quiet operation. It uses all of the Diamond opener technology and adds a belt drive system that absorbs vibration and noise, ensuring advanced, smooth, 'Whisper Quiet' operation.

### Multi Piece Knock Down, Pre-Assembled C Rail Version

**PART NO.**  
**062709**

#### Contains

062705	Powerhead
062724	Multi piece 3150mm C Rail/Belt kit
	2 x 4 button keyring transmitter
	1 x 4 button wall button

### 1 Piece Pre-Assembled C Rail Version

**PART NO.**  
**062708**

#### Contains

062705	Powerhead
062723	1 piece 3150mm C Rail/Belt kit

## Specifications:

### Motor Specifications

**Short Term Pull Force** 800N

**Stand-by Power Rating @ 230V** 2.2W

### Motor

**Voltage** 230-240 Volts AC-50Hz only

**Transformer** 24V DC

### Drive Mechanism

**Drive** Timing belt with one-piece rail trolley on C Rail

**Length of Travel** Adjustable to 2.7m shuttle travel

**Travel Rate** 100mm per second

**Lamp** On when door starts, off 4 minutes (adjustable) after stop

**Lamp Type** 2 x LED arrays

**Door Linkage** Adjustable door arm. Pull cord manual trolley release

### Safety

**Personal** Push button and automatic stop in down and up direction

**Electronic** Automatic safety obstruction force with reprofiling and user adjustable features

**Electrical** Motor overload protector

**Limit Device** Automatic limit positioning system

**Limit Adjustment** Automatic

### Dimensions

**Length (overall)** 3330mm

**Minimum Clearance Requirement** 25mm (highest point of top panels travel and lowest point of C Rail)

**Hanging Weight** 11.5kg

### Receiver

**Operating Frequency** UHF Multi frequency FM (Tri-Tran™ technology)

**Transmitter Capacity** 14

**Wall Button** Wireless 4 button

**Receiver/Transmitter Type** UHF Multi frequency FM (Tri-Tran™ technology)

### Warranty

**Warranty (Years)** 5 years/  
10,000 cycles



An **alesco** Company



## Features:

- Quiet, powerful DC motor - gives smooth, quiet and reliable operation.
- C Rail system encloses moving parts, ensuring a safer cleaner looking rail system.
- Automatic force sensing.
- Pet mode.
- Vacation mode.
- Auto-close.
- Independant courtesy light.
- Belt drive - ensures whisper quiet operation with added strength and reliability.
- 4 Channel transmitter.
- Positive locking.
- Terminal block providing connections for accessories ie, safety IR beams.
- In-built automatic safety reverse system.
- Adjustable courtesy light.
- Manual disengagement cord.
- Automatic reset after a power failure.
- Tri-Tran technology for greater reliability and minimal interference.
- Infra-red beam compatible.
- Compatible with PG-3 programmer.
- Battery backup and solar compatible.
- Soft start/soft stop.

## Method of operation:

Activate the opener by either the wall button, outside key switch or keyless entry system, the transmitter or manually open the door, by pulling the release handle down.

## Lifting capacity:

Suitable for most sectional and tilting garage doors up to 18m<sup>2</sup>.

## Door type:

Standard residential sectional, overhead and tilting garage doors.

Not suitable for high cycling doors.





# Controll-A-Door® P

DIAMOND WQ - WHISPER QUIET

Product Code  
062708/062709

## Spare parts:

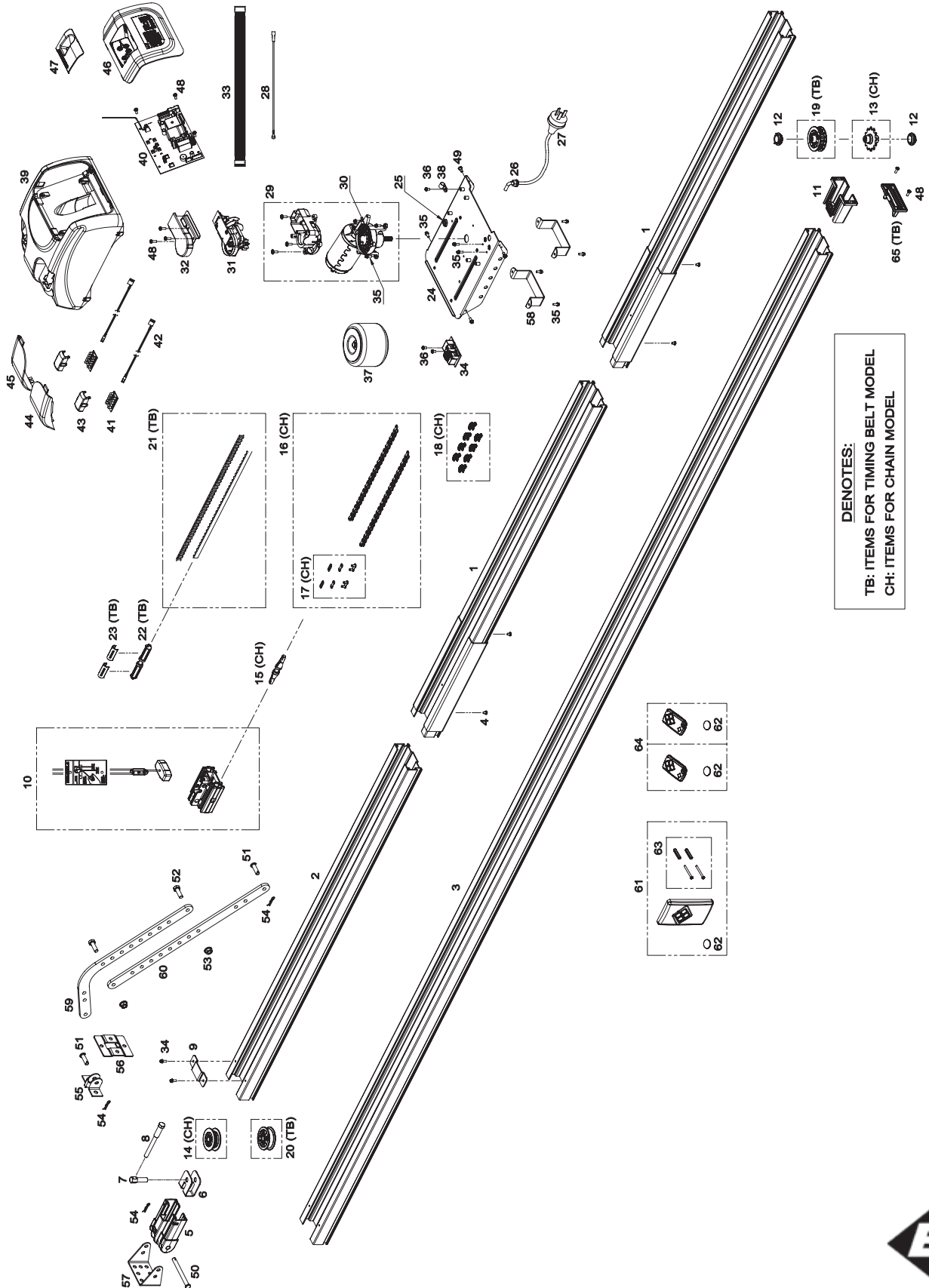



## Spare parts list:

ITEM NO.	PART NO.	DESCRIPTION
1	062723	C Rail 1050 VP1 Assy
2	062817	Extrusion 1050 End VP2
3	062816	Extrusion 3150 VP2
4		Taptite Screw 'S' Black M4x6
5	062819	Tension Support Assy
6	062822	Tension Bracket
7	062823	Hex Shaft 10-40
8	062824	Shoulder Screw M8x65
9	062827	Clamping Bracket VP1
10	062810	Shuttle VP2 Assy
11	062836	Pulley Support
12	062837	Flange Bush 16-10
13	062839	Sprocket 12T-12.7
14	062820	Chain Idler
15	062811	Chain Index V3
16	062812	Chain 1/2"x1/8" (487 Links) W/2CL
17		Chain Joint Link
18	062814	Chain Clip IM Kit
19	062840	Timing Pulley 16T10 Assy
20	062821	Timing Idler
21	062841	Timing Belt T10-6280
22	062842	Timing Index Clamp
23	062843	Timing Index Sleeve
24		Metal Chassis VP1 Assy
25		Grommet 101422
26		Cord Grip Grommet SB5P-2
27	062792	Power Cord 1.5M W2P+1R
28	062788	Wire Earth Assy 220L
29	062794	Geared Motor Assy 14-V2
30		Helical Gear 85075-12 CP Assy
31	062790	Timing Assy
32		Dust Cover Top
33	062789	Timing Harness 350 Assy

ITEM NO.	PART NO.	DESCRIPTION
34	062791	EMC Filter Board EMC 3.02
35		Flange Taptite Screw 'S' M4x10
36		Pan Head Screw W/Washer M4x8
37	062793	Transformer TDB-150-08 Kit
38		Cable Clamp ACC-2.5 (3/16")
39	062779	Main Cover VP2 SP Assy
40	062780	Control Board DCB01-1.00-101D
41		LED Light LT01
42	062785	Ribbon 2 Cord 300mm Assy
43	062759	Light Module Diffuser
44	062784	Light Diffuser Right VP2
45	062783	Light Diffuser Left VP2
46	062781	Back Cover VP2 Assy
47	062782	Controls Cover SP VP2
48		Taptite Screw 'P' M4x12
49		Shoulder Screw 5-M4x6
50	062802	Clevis Pin 90mm
51	062807	Clevis Pin 0829
52		Hex Head Screw M8x25
53		Hex Serration Flange Nut M8
54	062804	Pin Snap SSP ZNU 31080
55	062808	Door Bracket
56	062809	Door Bracket Locator
57	062803	Wall Bracket
58	062825	Track Bracket VP2
59	062805	Bent Arm
60	062806	Straight Arm
61	062733	Wall Transmitter WTB-4 RG SV1
62		Lithium Battery 3V CR2032
63		Plastic Wall Plug Pack
64	062732	Transmitter TB-4 Twin Pack
65		Belt Guide VP2

